

Regulations of Rigging Equipment Construction in Sky Dome Exhibition Hall

Revised Mar., 2019

1. Purpose:

These Guidelines are established in accordance with the TAITRA Construction Contractor Safety and Health Guidelines of Taiwan External Trade Development Council (“TAITRA”) in order to comply with occupational safety and health legislation, ensure the safety of construction staff and protect the facilities of TaiNEX 1.

2. Application Area:

Rigging equipment work performed at the Sky Dome of TaiNEX 1.

3. Construction Rules:

- 1). Depending on the requirements, the user shall acquire information from its establishment, installation or furnishing suppliers for stage, lighting, laser, stereo, photography or advertisements to seek **certification by civil or structure engineer**, which shall be submitted to TAITRA **along with Rigging Application Form** for reference at least 5 working days before move-in.
 - A. Certification by civil or structure engineer: Must include **List of Objects on Rigging, Rigging layout plan and Calculation Detail of Rigging Weight**.
 - B. **Application form of Rigging Construction**.
- 2). Maximum weight load per rigging is **500 kg**, with an interval of **9 meters** and the minimum height of **15 meters**. No ceiling truss coating shall be damaged by rigging construction. Ceiling trusses shall be wrapped in advance by weight-resistant fabric suspenders before connection with any type of qualified hook, chain or rim.
- 3). When any rope is hung from rigging for photography cableway purpose, if the cable distance is within 150 meters, there shall be at least 2 rigging at each end to share the cable pull. If the cable distance exceeds 150 meters, a weight allocation tower shall be arranged and no cable shall be hung from any rigging in TaiNEX 1.
- 4). In accordance with “Regulations on work at Taitra Venues”, constructor shall first examine the work environment and make sure the safety procedures of work place before proceeding construction. The user shall also provide construction staff with education on the work environment and hazard disclosure.
- 5). The above application (including all appendix) shall be consistent with not only existing fire safety and occupational and health related legislations of the competent authorities but also TAITRA’s applicable regulations.
- 6). If the lessee breaches any regulation of the competent authority or if the onsite construction work is inconsistent with the submitted materials, TAITRA may suspend the user’s work and seek correction immediately. The lessee shall resume construction once carried out the improvement and confirmed by TAITRA.
- 7). If TAITRA is subject to any fine or penalty imposed by the competent authority due to breach of applicable regulations of the competent authority, the lessee shall bear all penalty and it will be deduct from the security deposit.
- 8). If the lessee fails to submit the above required forms 5 days before move-in, TAITRA shall charge NT\$1,000 breach penalty for each day of delay and the amount may be deducted from the security deposit.
- 9). TAITRA may suspend the move-in if the lessee does not submit above required forms on the first move-in date.

- 10). The construction work shall be performed in compliance with TAITRA's staff access regulations and applicable procedure shall be completed.
 - 11). The lessee shall be responsible for the protection of the facilities and equipment of TaiNEX 1. In case of damage, the lessee shall compensate TAITRA or the third party suffered from the damage.
 - 12). The lessee shall clean up the construction area daily. Any waste left onsite and any construction area that is not cleaned up may be removed and cleaned up by a third party appointed by TAITRA under the lessee's cost. The amount may be deducted from the security deposit.
 - 13). If rigging work causes damage to ceiling truss, wall surface or pillar surface, or causes any painting peel-off, the lessee shall be in charge of repairment once all objects on rigging are removed. TAITRA may proceed repairment by a third party under lessee's cost if the repaired is not made. The amount may be deducted from the security deposit.
4. Insurance during move-in/out period and event period are required. It should be in accordance with the terms and conditions of the event contract.
 5. These Guidelines are implemented from the date of publication. If there is any matters not mentioned herein, it shall be separately issued and announced.

List of Objects on Rigging

No.	Name and Diagram of Equipment	Unit Weight	Quantity	Total Weight
1				
2				
3				
4				
5				
6				
7				
8				
9				
10				

* Please feel free to extend the pillar for more items.

Rigging Layout Plan

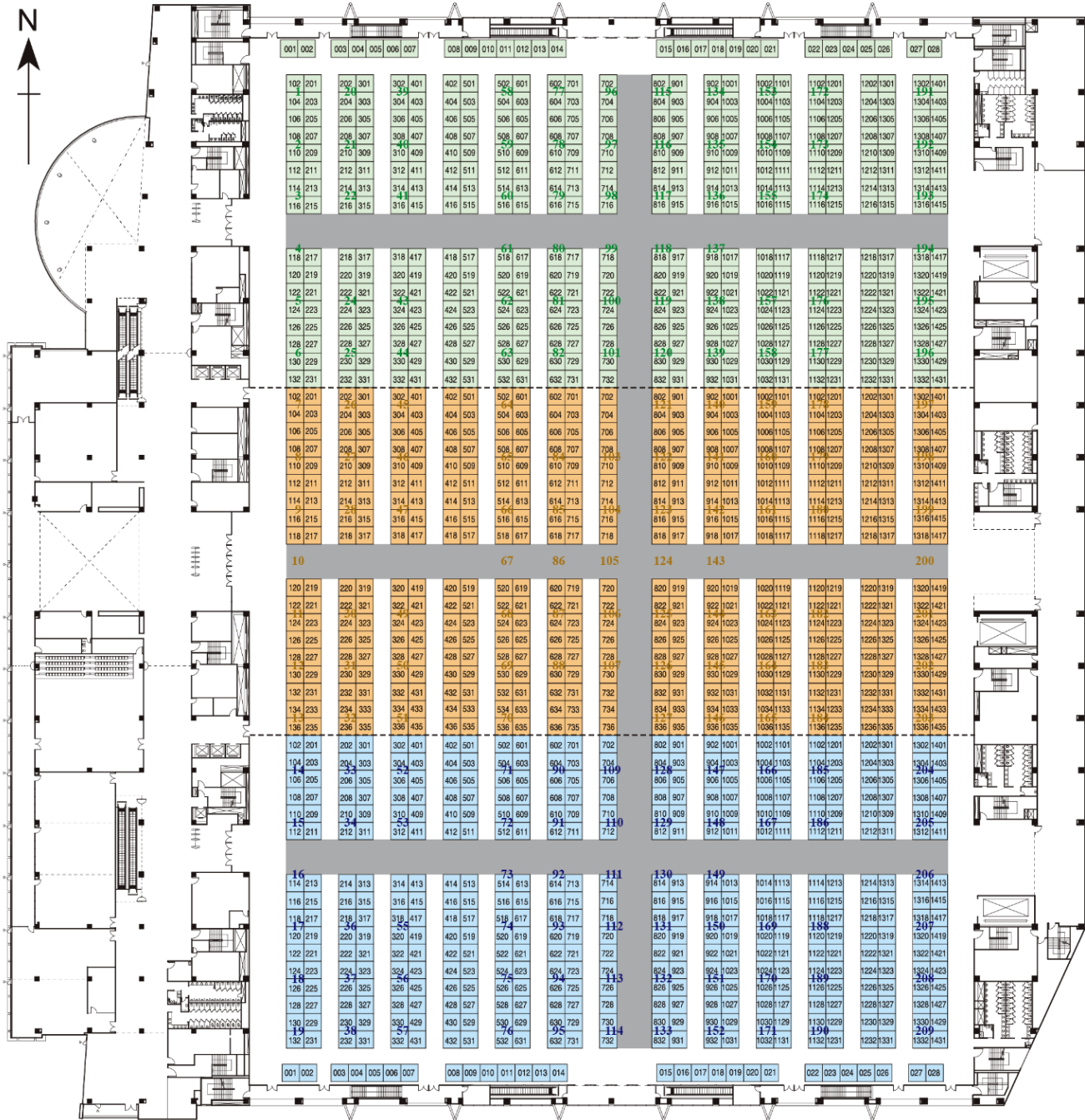

Sky Dome Rigging Layout Plan (booths included)

193 rigging affixed to the ceiling truss of the Sky Dome exhibition hall, as indicated in green, orange and blue numbers. Black numbers are standard booths in the Sky Dome exhibition hall.

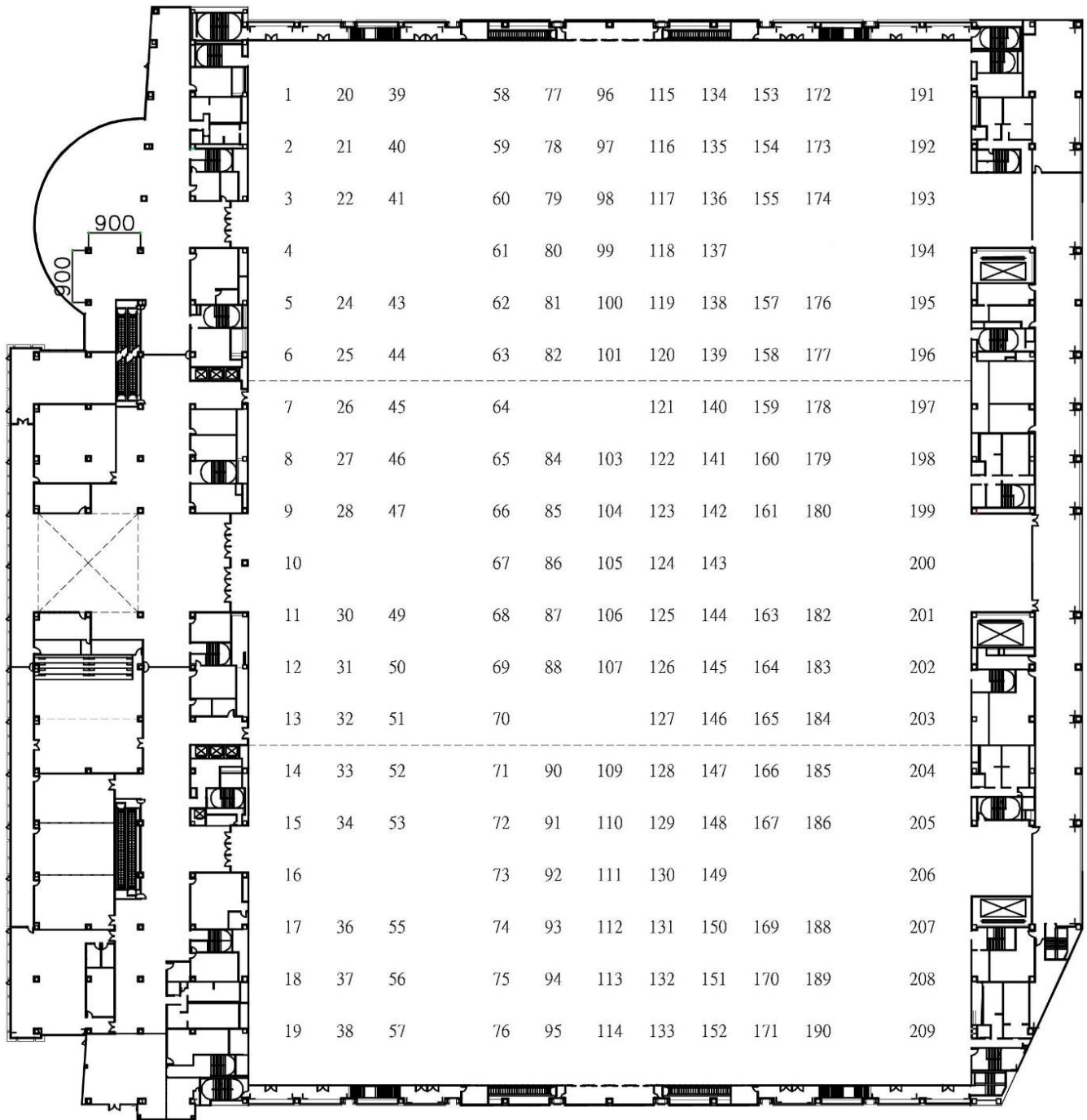

Sky Dome Rigging Layout Plan (booths excluded)

Calculation Detail of Rigging Weight

No.	Rigging No.	Suspended Object	Calculation Detail
1			
2			
3			
4			
5			
6			
7			
8			
9			
10			

* Please feel free to extend the pillar for more items.

Application for Rigging Construction

To: Taiwan External Trade Development Council (TAITRA)

We will hold _____ in Taipei Nangang Exhibition Center, Hall 1. Riggings are required in this event, we would like to apply for a total of __ __ riggings from the ceiling truss of Sky Dome Exhibition Hall. We guarantee that all equipment will be dismantled at the end of the event. We will fully comply with TAITRA's procedures and related regulations and will undertake necessary protection measures in accordance with occupational safety and health legislations (with special reinforcement in the prevention of fire and explosion and the occurrence of falling object and electrical disaster). In case of any property damage, personnel injury, death or other infringement due to design, construction, use or dismantlement, we will bear all legal liabilities and also guarantee to hold TAITRA harmless from any civil and criminal lawsuit. Otherwise we will compensate TAITRA against all damages, including litigation fee and attorney's fee.

Exhibition / Event		
Rental Period	from ____Year____ Month____Day to ____Year____ Month____Day	
Location and Number of Rigging	Area L	
	Area M	
	Area N	

Lessee: _____ (Signature)

Person in Charge: _____

Address: _____

Tel: _____ Mobile: _____ Email: _____

※This application form should be submitted along with a certification by civil or structure engineer at least 5 working days before move-in. TAITRA may charge NT\$1,000 breach penalty for each day of delay and the amount may be deducted from the security deposit. If the submission is not made on the first move-in date, TAITRA may suspend the event.